

Form-work Profiles and Accessories

Plug

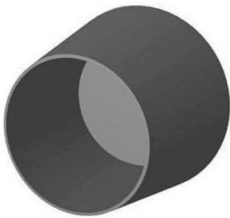

| CODE | DESCRIPTION | DIAMETER Ø mm | PACKING pcs |
|------|-------------|---------------|-------------|
| S21 | Plug | 22 | 2000 |

Plug ideal for closing the opening left by spacing bar

Cone



| CODE | DESCRIPTION | DIAMETER Ø mm | PACKING pcs |
|------|-------------|---------------|-------------|
| S22 | Cone | 22 | 2000 |

Cone which fits inside shuttering bar

Plug Water Barrier



| CODE | DESCRIPTION | DIAMETER Ø mm | PACKING pcs |
|------|-------------|---------------|-------------|
| S23 | Plug | 22 | 2000 |

Plug which fits spacer bar to water barrier

PVC Pipe



| CODE | DESCRIPTION | LENGTH mm | PACKING pcs |
|------|-------------|-----------|-------------|
| C1 | Pipe | 3000 | 25 |
| C2 | Pipe | 2000 | 25 |

Sleeves, shuttering spacer bar

Packing Leveling Shim



| CODE | DESCRIPTION | THICKNESS mm | PACKING pcs |
|------|-------------|--------------|-------------|
| S24 | Shim Pad | 2 | 1000 |
| S25 | Shim Pad | 3 | 1000 |
| S26 | Shim Pad | 3 | 500 |
| S27 | Shim Pad | 3 | 250 |

Solid shim for leveling precast panel